

4487 Pacific Street, Rocklin

FOR LEASE | ±11,400 SF WAREHOUSE WITH OFFICE AND YARD



RICK PHILLIPS
Managing Director
CA DRE #01061757
(916) 789-3349
rphillips@gallellire.com



GALLELLI REAL ESTATE
(916) 784-2700
www.GallellIRE.com

PROPERTY DETAILS

Property Details:

- ±11,400 SF
- Zoned C-2
- 400 Amp Service
- Excellent Freeway Access
- High Identity Site

Office Breakdown:

- ±2,400 SF Office
- Five (5) Private
- Breakroom
- Two (2) Restrooms

Yard Breakdown:

- Approx. ±8,000 SF
- Paved and Fenced

Warehouse Breakdown:

- ±9,000 SF Warehouse
- Insulated with Skylights
- Clear Span
- Fully Sprinklered
- Mezzanine Storage
- One (1) Restroom
- Four (4) Grade Level Overhead Doors
- 16'-18' Clear Height
- Upgraded Lighting



**LEASE RATE:
\$13,750/MONTH; NNN**



FLOOR PLAN

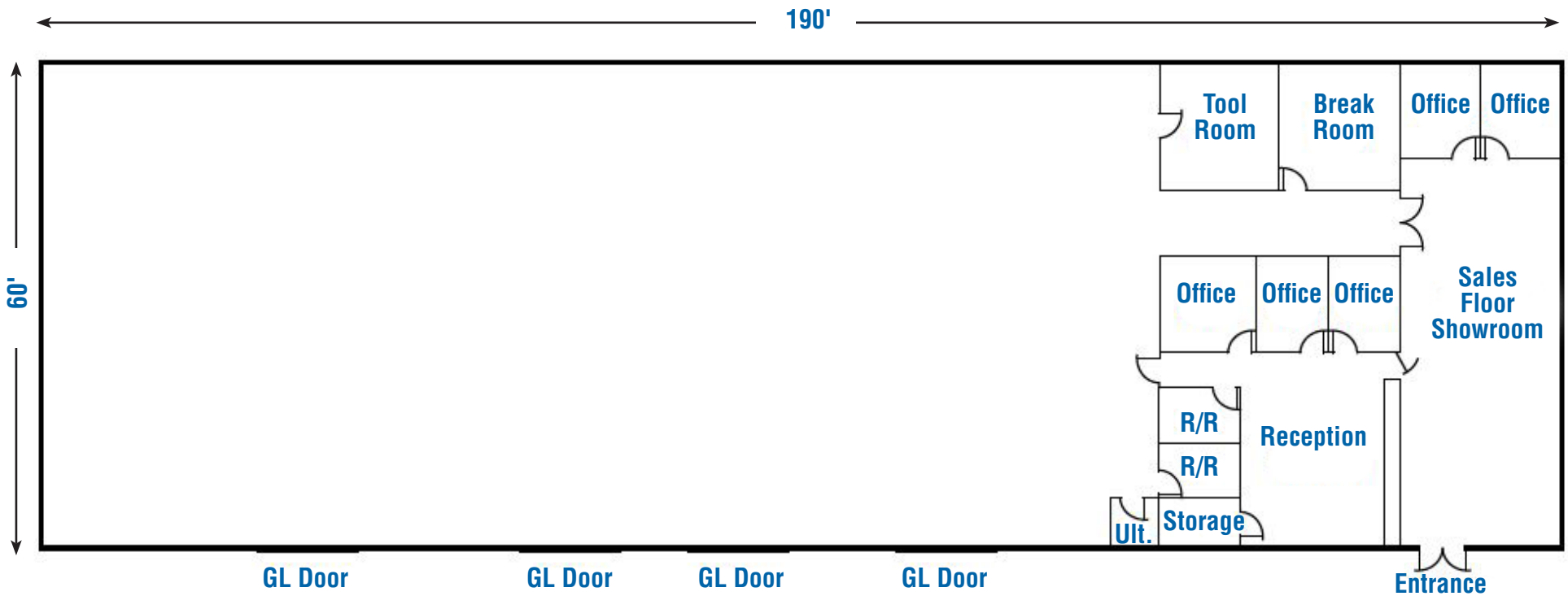

DEMOGRAPHICS

MARKET OVERVIEW

4487 Pacific St, Rocklin, CA 95677

2023 - 3 Mile Radius

KEY FACTS

POPULATION	74,169	AVERAGE HOUSEHOLD SIZE	2.7
MEDIAN AGE	40	MEDIAN HOUSEHOLD INCOME	\$112,507

EDUCATION

15.92%	23.31%	42.13%
HIGH SCHOOL GRADUATE	SOME COLLEGE	BACHELOR/GRAD/DOC DEGREE

HOUSING STATISTICS

\$557,715	27,328	34.38%
MEDIAN HOME VALUE	HOUSEHOLDS	% RENTER OCCUPIED HOUSING UNITS

BUSINESS

33,624
TOTAL EMPLOYEES

COMMUTERS

1.13%	88.71%
USED PUBLIC TRANSPORTATION	DROVE ALONE TO WORK

EMPLOYMENT

72.77%	27.23%
WHITE COLLAR	BLUE COLLAR

SURROUNDING AERIAL



SHRED
BE ER CO

enterprise

Pacific St

4487 PACIFIC ST

Sierra Meadows Dr

Grove St

AMF
BOWLING

FOR MORE INFORMATION PLEASE CONTACT

RICK PHILLIPS

Managing Director
CA DRE #01061757
(916) 789-3349
rphillips@gallellire.com

GALLELLI REAL ESTATE

3005 Douglas Boulevard, Suite 200
Roseville, CA 95661
916-784-2700
GallelliRE.com



Gary B. Gallelli, Broker
CA DRE #00811881